

CLUTCH RELEASE CYLINDER COMPONENTS

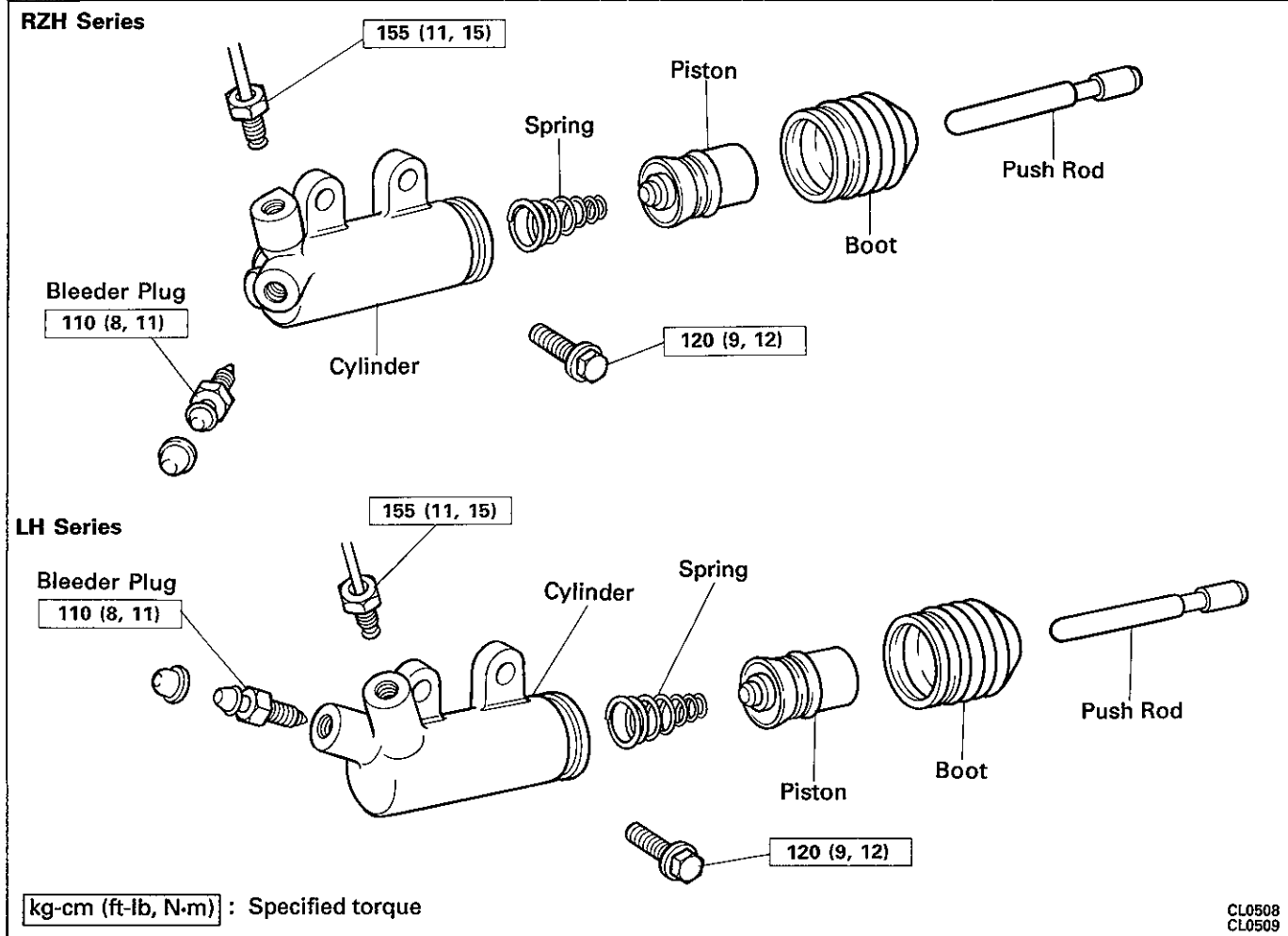

REMOVAL OF RELEASE CYLINDER

- 1. DISCONNECT CLUTCH LINE UNION**
Using SST, disconnect the union.
SST 09751-36011
- 2. REMOVE TWO BOLTS AND PULL OFF RELEASE CYLINDER**

DISASSEMBLY OF RELEASE CYLINDER

- 1. PULL OUT PUSH ROD**
- 2. REMOVE BOOT**
- 3. REMOVE PISTON**

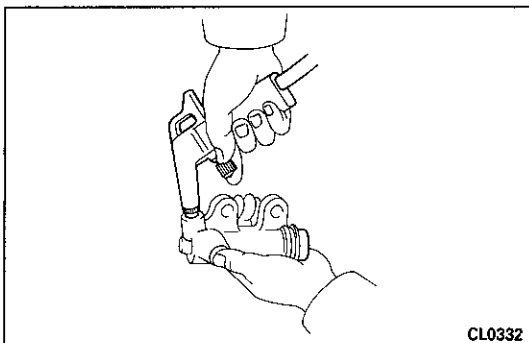

INSPECTION OF RELEASE CYLINDER

HINT: Clean the disassembled parts with compressed air.

1. **INSPECT RELEASE CYLINDER BORE FOR SCORING OR CORROSION**

If a problem is found, clean or replace the cylinder.

2. **INSPECT PISTON AND CUPS FOR WEAR, SCORING, CRACKS OR SWELLING**

If either one requires replacement, use the parts from the cylinder kit.

3. **INSPECT PUSH ROD FOR WEAR OR DAMAGE**

If necessary, replace the push rod.

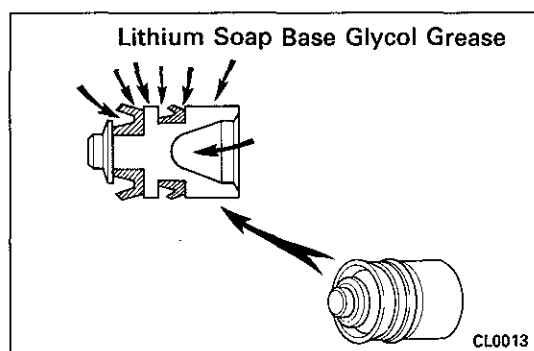

ASSEMBLY OF RELEASE CYLINDER

(See page CL-8)

1. **COAT PISTON WITH LITHIUM SOAP BASE GLYCOL GREASE, AS SHOWN**
2. **INSTALL PISTON**
3. **INSTALL BOOT AND INSERT PUSH ROD**

INSTALLATION OF RELEASE CYLINDER

(See page CL-8)

1. **INSTALL RELEASE CYLINDER WITH TWO BOLTS**
2. **CONNECT CLUTCH LINE UNION**
Using SST, connect the union.
SST 09751-36011
3. **BLEED CLUTCH SYSTEM**
(See page CL-4)